

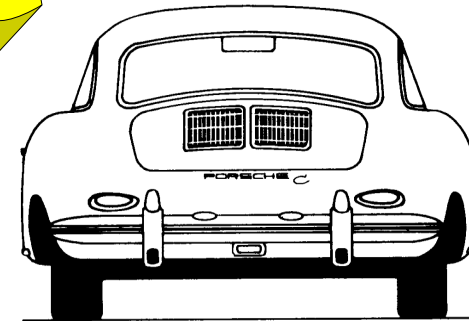

**Hellenic  
Motor  
Museum**  
THEODORE & JOANNA  
CHARAGIONIS'  
FOUNDATION 1977

# Visitor's Manual

Please spend 2'  
to read me



**Hellenic  
Motor  
Museum**  
THEODORE & JOANNA  
CHARAGIONIS'  
FOUNDATION 1977

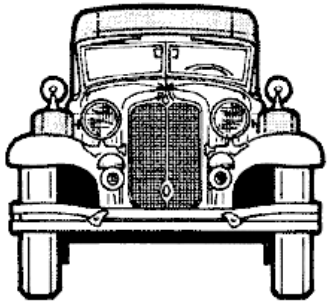

# Welcome to the HELLENIC MOTOR MUSEUM

Dear Visitors,

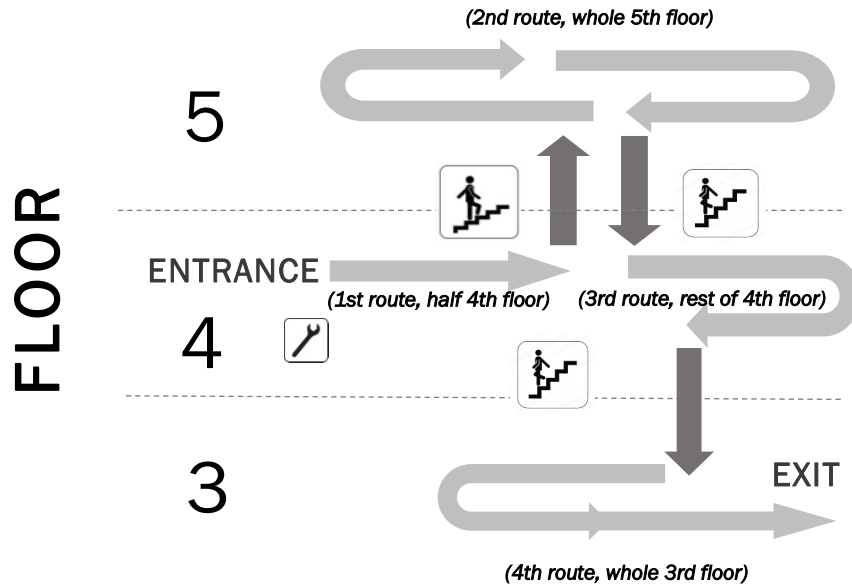

- |       |                   |                    |
|-------|-------------------|--------------------|
| 4     | ➔ MUSEUM ENTRANCE | 🎥 AUDITORIUM       |
|       |                   | 🚻 WC               |
| <hr/> |                   |                    |
|       | 🎫 TICKETING       | 🏎️ F1 SIMULATOR    |
| 3     | 📺 GIFT SHOP       | 🚻 WC               |
|       | EXIT              | ☕ VENTING MACHINES |

1

**Photo shooting** by portable cameras **is allowed**. For professional photo shooting, address to Museum's reception.

2

**Food and Beverage are not allowed** into the Museum.

3

**Cord barriers** demarcate the space that you **can approach** the exhibits and are mounted **low** as well as explanatory signs, not to intervene your sight and photos.

**Exhibits** are presented in **four thematical sections** and are laid in chronological order, so to offer an integrated experience. Museum's **entrance** is on the **4th floor** where you can admire cars of decades '10 and '20 (**1st section**) as well as the 1930s garage with over 3000 objects.

4

After completing, **move to the 5th floor** where you will find milestone cars of the late '30s to '60s (**2nd section**) and "**Transparency**" permanent exhibition, focused on internal mechanical parts of all types of engine mounting in chassis of front and rear drive.

Continue your visit coming **back again** to the **4th floor (3rd section)**, where you will find "**Made by Hellas**"; a permanent exhibition dedicated to the course of Greeks involving cars, within and outside country's frontiers, and their innovative ideas that influenced essentially global automobile industry.

5

Descending to the **3rd floor (4th section)**, you will find some of the most beautiful **Italian** creations of the 1960s, '70s and '80s.



To protect exhibits in an excellent shape for you, a CCTV (Close Circuit Television), records all visits, so remember to put a smile on for us now and then! 😊

*Thank you for visiting us! We're looking forward to see you again!*